

DIN 6912

Cylinder screws

Hexagon socket with key guide | low head

Steel 08.8 | bright | Cr(VI)-free | Metric thread

Further information: Due to their head geometry, these screws are limited in their load bearing capacity, see DIN EN ISO 898-1

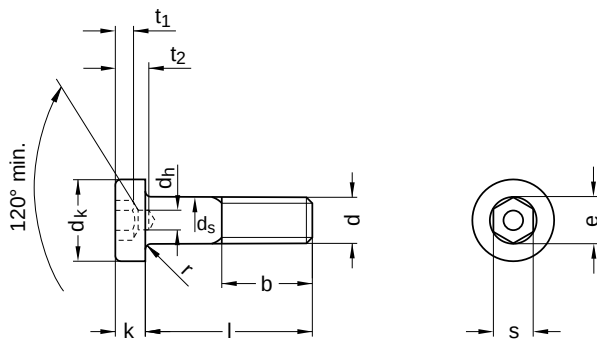

Diameter (d)	b			dh		dk		ds		k	
	l up to 125	l up to 200	l longer than 200	min.	max.	min.	max.	min.	max.	min.	max.
M4	14	–	–	2.0	2.06	6.78	7.0	3.82	4	2.66	2.8
M5	16	–	–	2.5	2.56	8.28	8.5	4.82	5	3.32	3.5
M6	18	–	–	3.0	3.06	9.78	10.0	5.82	6	3.82	4.0
M8	22	–	–	4.0	4.08	12.73	13.0	7.78	8	4.82	5.0
M10	26	32	–	5.0	5.08	15.73	16.0	9.78	10	6.28	6.5
M12	30	36	–	6.0	6.08	17.73	18.0	11.73	12	7.28	7.5
M14	34	40	–	7.0	7.09	20.67	21.0	13.73	14	8.28	8.5
M16	38	44	57	8.0	8.09	23.67	24.0	15.73	16	9.78	10.0
M20	46	52	65	10.0	10.09	29.67	30.0	19.67	20	11.73	12.0
M24	54	60	73	12.0	12.11	35.61	36.0	23.67	24	13.73	14.0
M30	66	72	85	15.0	15.11	44.61	45.0	29.67	30	17.23	17.5

Diameter (d)	e min.	r min.	s			Pitch (P)	t2		t1			Tool size
			nominal size	min.	max.		min.	max.	nominal size	max.	min.	
M4	3.44	0.20	3	3.02	3.10	0.70	3.3	3.60	1.6	1.72	1.48	SW 3
M5	4.58	0.20	4	4.02	4.12	0.80	4.0	4.30	2.0	2.12	1.88	SW 4
M6	5.72	0.25	5	5.02	5.14	1.00	5.0	5.30	2.5	2.62	2.38	SW 5
M8	6.86	0.40	6	6.02	6.14	1.25	6.5	6.86	3.0	3.12	2.88	SW 6
M10	9.15	0.40	8	8.02	8.18	1.50	7.5	7.86	3.5	3.65	3.35	SW 8
M12	11.43	0.60	10	10.02	10.18	1.75	9.0	9.36	4.0	4.15	3.85	SW 10
M14	13.72	0.60	12	12.03	12.21	2.00	10.0	10.36	4.5	4.65	4.35	SW 12
M16	16.00	0.60	14	14.03	14.21	2.00	11.5	11.93	5.5	5.65	5.35	SW 14
M20	19.44	0.80	17	17.05	17.23	2.50	14.0	14.43	6.5	6.68	6.23	SW 17
M24	21.73	0.80	19	19.06	19.28	3.00	16.0	16.43	7.0	7.18	6.82	SW 19
M30	25.15	1.00	22	22.06	22.28	3.50	19.0	19.52	9.0	9.18	8.82	SW 22

All technical data refer to the measure mm



DIN 6912

Cylinder screws

Hexagon socket with key guide | low head

Steel 08.8 | bright | Cr(VI)-free | Metric thread

nominal size	Length (l)	
	min.	max.
8	7.72	8.29
10	9.71	10.29
12	11.65	12.35
14	13.65	14.35
16	15.65	16.35
18	17.65	18.35
20	19.58	20.42
25	24.58	25.42
30	29.58	30.42
35	34.50	35.50

nominal size	Length (l)	
	min.	max.
40	39.50	40.50
45	44.50	45.50
50	49.50	50.50
55	54.40	55.60
60	59.40	60.60
65	64.40	65.60
70	69.40	70.60
75	74.40	75.60
80	79.40	80.60
90	89.30	90.70

nominal size	Length (l)	
	min.	max.
100	99.30	100.70
110	109.30	110.70
120	119.30	120.70
130	129.20	130.80
140	139.20	140.80
150	149.20	150.80
160	159.20	160.80

Diameter (d)	Length (l)																										
	8	10	12	14	16	18	20	25	30	35	40	45	50	55	60	65	70	75	80	90	100	110	120	130	140	150	160
M4	●	●	●	●	●		●	●	●	●																	
M5		●	●	●	●	●	●	●	●	●	●	●	●	●	●												
M6			●	●	●	●	●	●	●	●	●	●	●	●	●	●	●	●	●	●	●		●				
M8		●	●	●	●	●	●	●	●	●	●	●	●	●	●	●	●	●	●	●	●						
M10					●	●	●	●	●	●	●	●	●	●	●	●	●	●	●	●	●	●					
M12					●		●	●	●	●	●	●	●	●	●	●	●	●	●	●	●	●					
M14							●	●	●		●	●		●		●	●	●	●	●	●						
M16							●	●	●	●	●	●	●	●	●	●	●	●	●	●	●	●	●	●	●	●	●
M20								●	●	●	●	●	●	●	●	●	●	●	●	●	●	●	●	●	●	●	●
M24															●	●	●	●	●	●	●	●	●	●	●	●	●
M30																	●	●	●	●	●	●	●	●	●	●	●

● Combinations available in the eShop | Other sizes on request

All technical data refer to the measure mm

