

DIN 7984
Cylinder screws

Hexagon socket | low head

Stainless steel A2 | Cr(VI)-free | Metric thread

Further information: Due to their head geometry, these screws are limited in their load bearing capacity, see DIN EN ISO 898-1

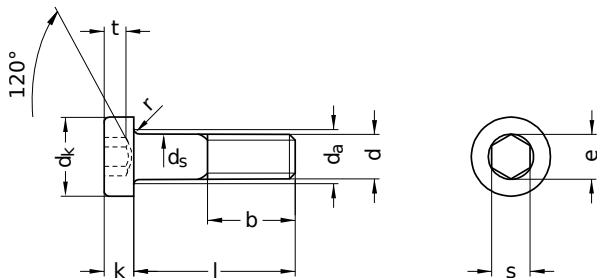

Diameter (d)	b			d _a max.	d _k		d _s		k	
	l up to 125	l up to 200	l longer than 200		min.	max.	min.	max.	min.	max.
M3	12	–	–	3.6	5.32	5.5	2.86	3	1.86	2.0
M4	14	–	–	4.7	6.78	7.0	3.82	4	2.66	2.8
M5	16	–	–	5.7	8.28	8.5	4.82	5	3.32	3.5
M6	18	–	–	6.8	9.78	10.0	5.82	6	3.82	4.0
M8	22	28	–	9.2	12.73	13.0	7.78	8	4.82	5.0
M10	26	32	–	11.2	15.73	16.0	9.78	10	5.82	6.0
M12	30	36	–	13.7	17.73	18.0	11.73	12	6.78	7.0
M16	38	44	57	17.7	23.67	24.0	15.73	16	8.78	9.0

Diameter (d)	e min.	r min.	s			Pitch (P)	t			Tool size
			nominal size	min.	max.		nominal size	max.	min.	
M3	2.30	0.10	2.0	2.02	2.10	0.50	1.5	1.62	1.38	SW 2
M4	2.87	0.20	2.5	2.52	2.60	0.70	2.3	2.42	2.18	SW 2,5
M5	3.44	0.20	3.0	3.02	3.10	0.80	2.7	2.82	2.58	SW 3
M6	4.58	0.25	4.0	4.02	4.12	1.00	3.0	3.12	2.88	SW 4
M8	5.72	0.40	5.0	5.02	5.12	1.25	3.8	3.95	3.65	SW 5
M10	8.01	0.40	7.0	7.02	7.18	1.50	4.5	4.65	4.35	SW 7
M12	9.15	0.60	8.0	8.02	8.18	1.75	5.0	5.15	4.85	SW 8
M16	13.72	0.60	12.0	12.03	12.21	2.00	5.5	5.65	5.35	SW 12

All technical data refer to the measure mm



DIN 7984

Cylinder screws

Hexagon socket | low head

Stainless steel A2 | Cr(VI)-free | Metric thread

nominal size	Length (l)	
	min.	max.
5	4.76	5.24
6	5.76	6.24
8	7.71	8.29
10	9.71	10.29
12	11.65	12.35
14	13.65	14.35
16	15.65	16.35
20	19.58	20.42
22	21.58	22.42
25	24.58	25.42

nominal size	Length (l)	
	min.	max.
30	29.58	30.42
35	34.50	35.50
40	39.50	40.50
45	44.50	45.50
50	49.50	50.50
55	54.40	55.60
60	59.40	60.60
70	69.40	70.60
80	79.40	80.60

Diameter (d)	Length (l)																			
	5	6	8	10	12	14	16	20	22	25	30	35	40	45	50	55	60	70	80	
M3	●	●	●	●		●	●	●												
M4		●	●	●	●	●	●	●		●										
M5			●	●	●		●	●		●	●	●	●							
M6				●	●	●	●	●		●	●	●	●	●	●	●		●		
M8				●	●		●	●	●	●	●	●	●	●	●	●	●	●	●	
M10							●	●		●	●	●	●		●		●	●	●	
M12								●		●	●	●	●	●	●	●		●		
M16														●	●					

• Combinations available in the eShop | Other sizes on request

All technical data refer to the measure mm

